

POPLAR

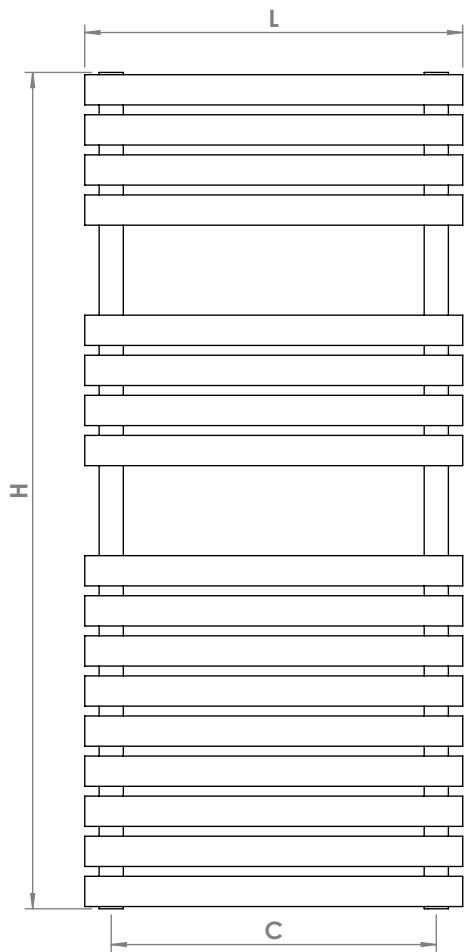

Front View

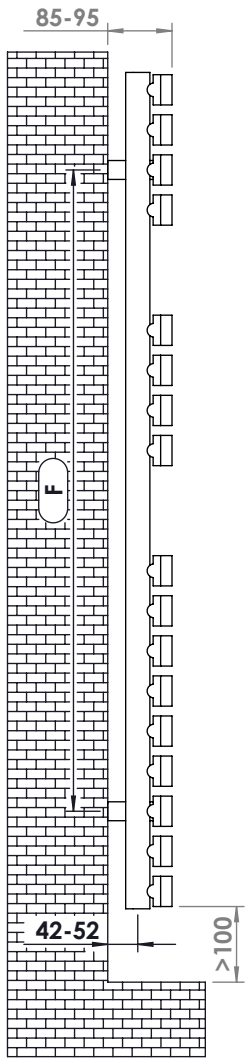

Side View

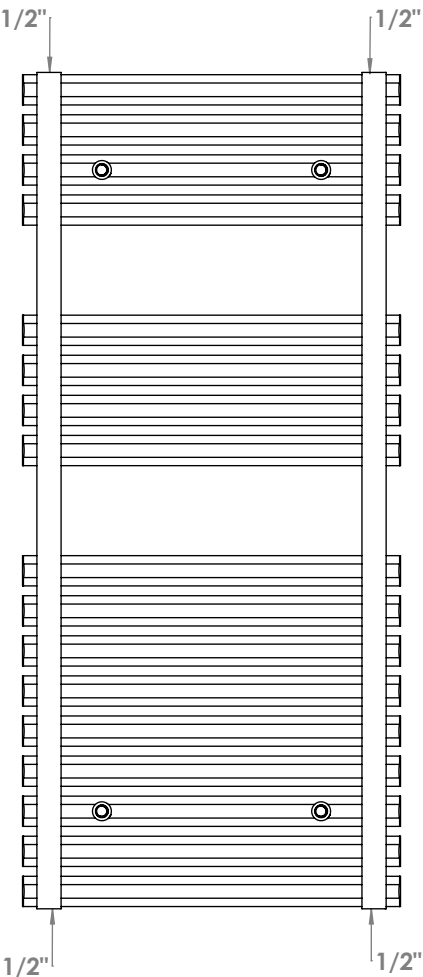

Back View

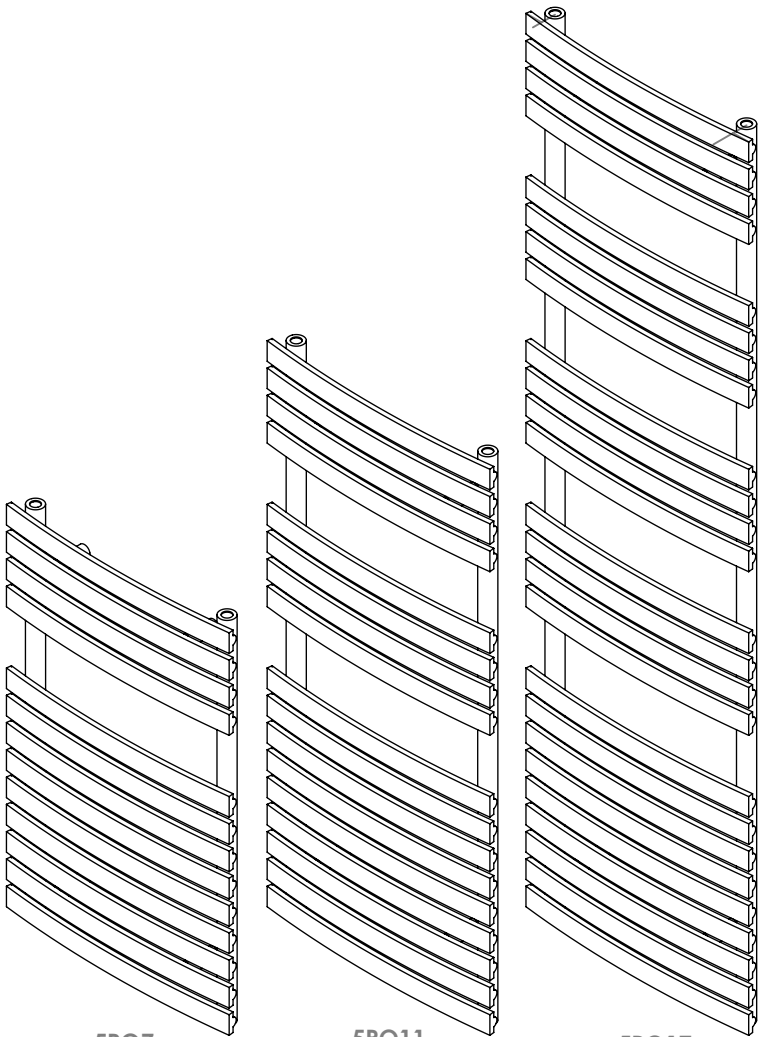

5PO7

5PO11

5PO17

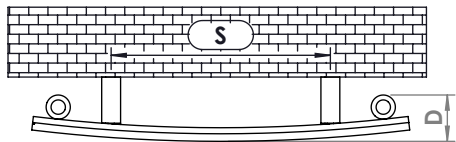

Top View

Installation Accessories:

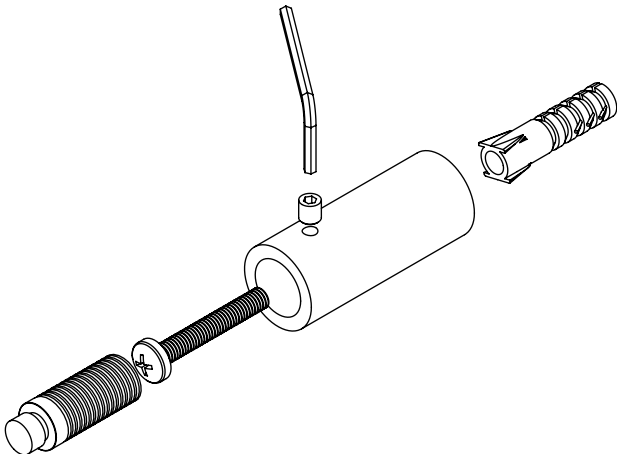
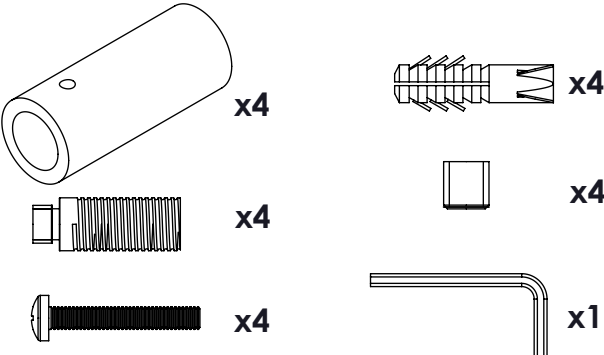

Plumbing Position:  
Vertical

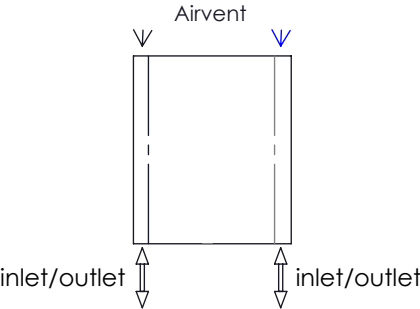

Vertical mount  
All Dimensions are in mm  
Max.Working Pressure: 10 Bar  
Max.Working Temperature: 95° C  
Inlet / Outlet : 1/2" BSP  
Fuel : E/H/D

PRODUCT CODE	Height	Length	Depth	Pipe Centres	Bracket Centres	
	H	L	D	C	F	S
	mm	mm	mm	mm	mm	mm
5PO7	788	500	60	430	636	290
5PO11	1106	500	60	430	848	290
5PO17	1742	500	60	430	1484	290